

NL-228A-66-CM-xxxx-0,70-yy

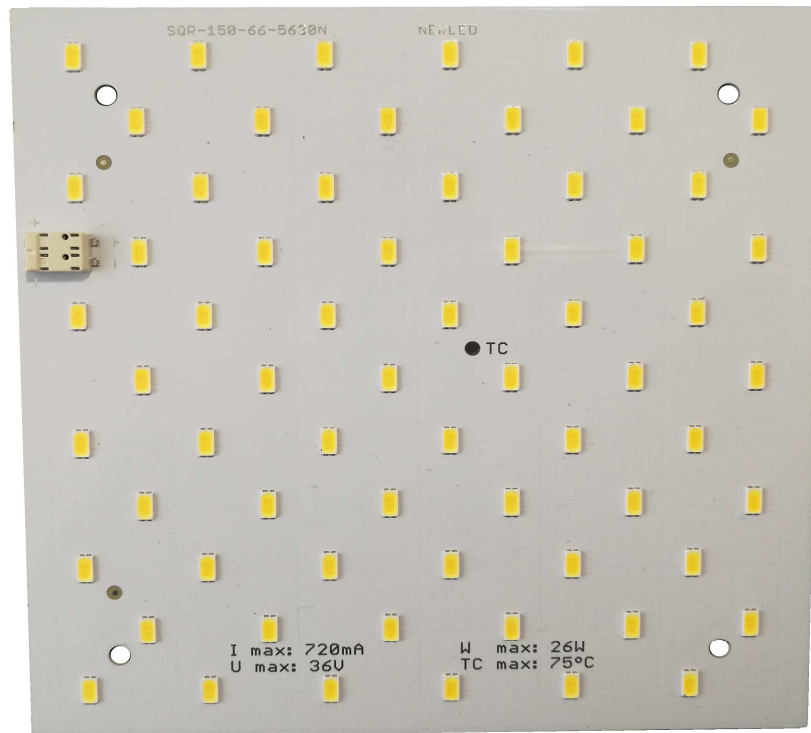

Dimensions: 150mm x 150mm



I max: 720mA
U max: 34V
W max: 24W
PCB: aluminum 1,6mm

www.newled.eu

product code	ord.no.	color temp.	no. of LEDs	current	system power	lum.flux Tc=25°C	efficacy Tc=25°C	lum.flux Tc=65°C	efficacy Tc=65°C	voltage
		K	pcs	mA	W	lm	lm/W	lm	lm/W	V
NL-228A-66-CM-3000-0,70-82	53275-30	3000	66	700	22,3	3818	171	3627	162	31,9
				600	19,1	3338	174	3171	166	
				500	16,0	2836	178	2694	169	
NL-228A-66-CM-4000-0,70-82	53275-40	4000	66	700	22,3	4043	181	3840	172	31,9
				600	19,1	3534	185	3358	175	
				500	16,0	3003	188	2853	179	
NL-228A-66-CM-5000-0,70-82	53275-50	5000	66	700	22,3	4155	186	3947	177	31,9
				600	19,1	3632	190	3451	180	
				500	16,0	3086	194	2932	184	

Color rendering index:
 Ra>80

Beam angle:
 120°

Ambient temperature Ta:
 -25°C ... +55°C

Module temperature Tc:
 max. +75°C

Lifetime L70:
 >60.000h @ Tc=+75°C
 (@ max. load)

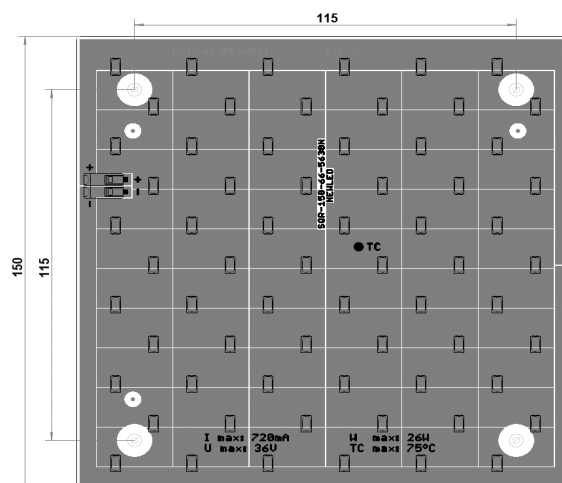

Connectors:
 1x 2-pin

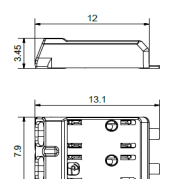

All specifications subject to change without prior notice. Values are +/- 10%.

Version 2019/03/11